

CR-2

UHF 無線麥克風系統
UHF Wireless Microphone System

Simple Operation Manual 簡易操作說明書

Before using the product, please read the simple operation manual and keep it in good condition.
使用產品前請仔細閱讀快速使用指南,并妥善保管

Introduction

Relacart CR-1 is a highly cost-effective UHF wireless microphone system, compatible with smart phones (3.5mm interface), digital / SLR cameras, portable cameras, recorders, tablets and other equipment to help pick up high-fidelity audio. It is suitable for interviews, microfilm recording or commercial demonstrations and other applications. The transmitter supports microphone input interface, and the receiver has earphone monitoring function. The effective working distance is about 80 meters in the open space. Both transmitter and receiver have the function of key lock to prevent user from misoperation.

Characteristic

- ◆ UHF wireless transmission, providing high fidelity sound source.
- ◆ Widely compatible with smart phones, digital SLR cameras, portable cameras, tape recorders, tablets, etc.
- ◆ Digital audio compression of DSP reduces the noise in wireless transmission system to the lowest level.
- ◆ 10 switchable frequencies to realize the operation without environmental interference.
- ◆ The volume of receiver and transmitter can be adjusted arbitrarily to adapt to the volume level of different equipment.
- ◆ Real-time monitoring function with headphones.
- ◆ Receiver and transmitter are powered by two AA batteries.

1

Bodypack Receiver

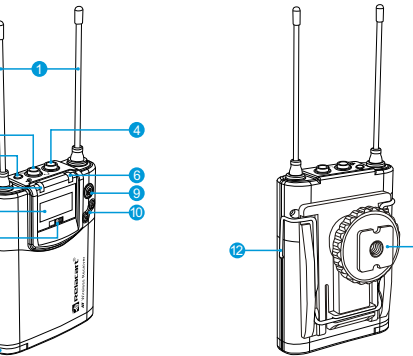

- 1 Receiving antenna.
- 2 Power switch: long press power to be on or off.
- 3 3.5mm audio output interface.
- 4 3.5mm headphone monitoring interface.
- 5 Blue: RX 1 signal input indication.
- 6 Blue: the receiver and transmitter are connected successfully.
- 7 OLED display: display frequency, channel, current battery capacity and other information.
- 8 Infrared counter frequency transmission window.
- 9 "⚙️" button: confirm to change menu setting and input display parameters.
- 10 "▲/▼" button: enter menu setting.
- 11 Battery bin: can hold 2 AA batteries.
- 12 Belt clip: Fix the receiver on the user's waist or fit into the groove of the shoe adapter handle.
- 13 Shoe adapter: for installing and fixing microphone on camera.

2

Bodypack Transmitter

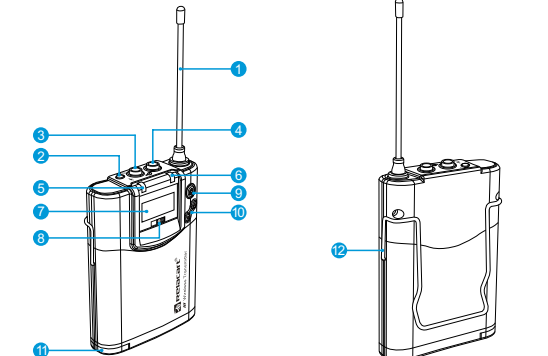

- 1 Transmitting antenna.
- 2 Power /MUTE switch: long press power to be on or off / Short press is mute.
- 3 3.5mm microphone input interface.
- 4 3.5mm audio input interface.
- 5 Blue: power indicator.
- 6 Blue: audio level indication.
- 7 OLED display: display frequency, channel, current battery capacity and other information.
- 8 Infrared counter frequency transmission window.
- 9 "⚙️" button: confirm to change menu setting and input display parameters.
- 10 "▲/▼" button: enter menu setting.
- 11 Battery bin: can hold 2 AA batteries.
- 12 Belt clip: fix the transmitter around the user's waist.

3

OLED Display operating instructions

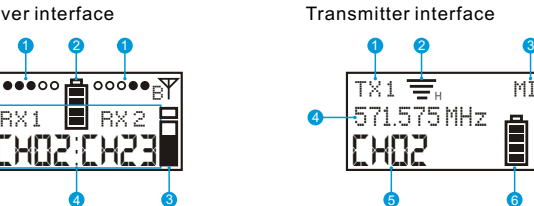

- 1 A, B signals
- 2 Battery index
- 3 Rx1, Rx2 RF output
- 4 Channel selection: Rx1(CH01-16)
Rx2(CH07-32)
- 5 Transmitter A
- 6 High and low transmitting power
- 7 MIC input
- 8 Battery index
- 9 RF input

- To set up the receiver or transmitter menu, follow these steps:
1. Press the "▲/▼" key to enter the menu setting.
 2. Press "▲/▼" again to scroll the menu bar.
 3. Press the "⚙️" key to enter the edit / confirm menu setting.

- How to set up MONO and STEREO
1. Press the "▲/▼" ("▲ / ▼ ") selection button to select " MONO " or " STEREO " .
 2. Press the "⚙️" key to confirm the setting.

Remark: the factory setting mode is MONO.



Subsequent settings are stored in memory. Next time when you turn on the transmitter, it will be automatically consistent with the mode set at the last shutdown.

4

How to connect the transmitter and receiver

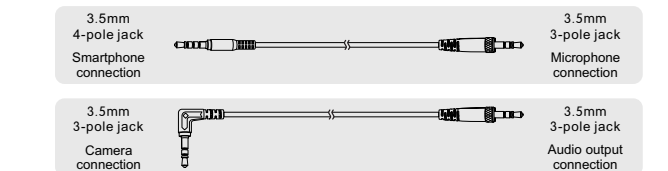
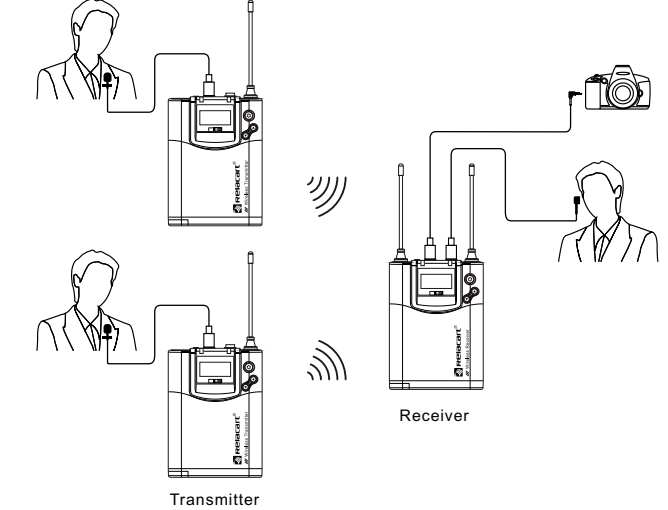

* Please connect the cable to the same terminal as above according to the equipment you use.

5

Install or disassemble shoe adapter

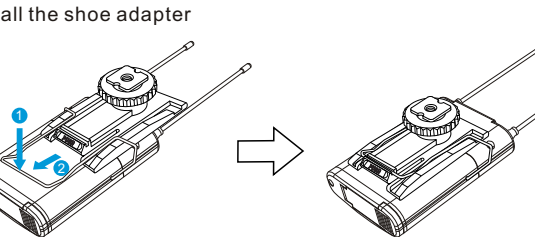

Push the bottom of the belt clamp (1) to create a certain space between the belt clamp and the receiver, align the belt clamp with the two vertical grooves on the shoe adapter, and then insert the adapter in the direction of the arrow (2) , fully push the shoe adapter until the belt clamp is fitted into the horizontal groove on the adapter handle.

Disassemble the shoe adapter

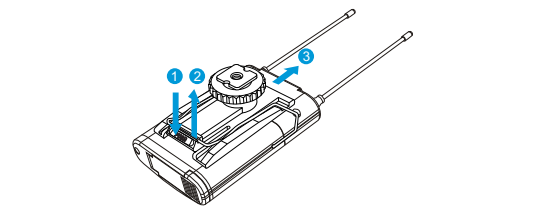

Push and hold the position marked " PUSH " on the shoe adapter (1) , separate the horizontal part of the belt clamp from the horizontal part and groove on the shoe adapter (2) , then push the shoe adapter in the direction of the arrow (3) .

6

Matching of receiver and transmitter

Before leaving the factory, the transmitter and receiver of each product have been set up in pairs, and can be used directly when starting.

If the radio signals of the transmitter and receiver are connected properly, the green light indicator of the receiver will be long on, and the parameters of the display screen will be the same as that of the transmitter; if not connected, the receiver indicator will not be on.

- Remark:
- Channel 1 and channel 2 of the receiver can be adjusted separately. When two transmitters are used, transmitter 1 and transmitter 2 do not need to keep the same channel.
- Just set CH-A receiver to the same channel as transmitter CH-A and CH-B of receiver to the same channel as transmitter CH-B.

1. If you use multiple CR-2 wireless microphone systems, make sure that each system is set to a different channel, which can reduce the possibility of mutual interference.
2. If the transmitter and receiver are connected, the status light of the receiver remains blue. Conversely, if the status light of the receiver is off, it means that the transmitter and receiver are disconnected.
3. The setting result will be saved in memory automatically. Turn on the transmitter and receiver again, and the channel, channel and other information will be consistent with the last setting.
4. Insert the headset into the receiver for monitoring. When the volume of the headset is low, gradually adjust the volume to a comfortable volume to monitor the transmission.
5. After confirming that the transmission quality is good, install the transmitter and receiver.
6. When you set the transmission channel, the transmitter cannot be used to transmit signals.
7. Do not remove the battery when setting the transmission channel.

- However, if the selected channel is noisy, perform the following steps:
1. Press the "▲、▼" keys of the transmitter to enter the menu setting.
 2. The receiver will automatically connect to the transmitter.
 3. Select the channel until you hear a clear sound.

7

Product Specification

CR-2			
RF Carrier Range	470MHz~960MHz	Dynamic Range	85 dB
Frequency Stability	0.005%	S/N (A-Weighted)	80 dB
Audio Frequency Response	50Hz ~ 1600Hz ±3dB	Audio sampling rate	48 KHz
Audio companding		DSP Audio companding	
Operating Range (environment dependent)		≥ 60 M	
T.H.D		≤ 1%, @1KHz	
Operating Temperature Range		-10℃ ~ +50℃	

CR-2R			
Receiving Bandwidth	470MHz~960MHz	Output Impedance	400 Ω
Receiving Mode	Superheterodyne	Battery Life	≥ 7 Hours
Image Rejection	45dBm	Power Requirements	AA 1.5V x 2
Maximum output Level	LINE: 0.5Vpp ; Phone: 1Vpp	Current Consumption	3V 160mA
Squelch Adjustment	built-in setting parameters	Overall Dimensions	95 x 65 x23(mm)
RF Sensitivity	when input is 10dBu, S/N ≥ 45dB		
Frequency Sync Mode	Manual key setting or infrared transmission		
Adjustment range of audio output level	9 levels adjustable, attenuation adjustment, every 2dB step		
Net Weight (without battery)	100g		

CR-2T			
Switching bandwidth	470MHz~960MHz	Harmonic Emissions	-32dBm
Frequency Generation	PLL synthesized	Modulation	FSK
RF Output Power	13.5 dBm	Max Input Level	250mV
Carrier Deviation	0.005%	Impedance	2.2KΩ
Power Requirements	AA 1.5V x2	Battery Life	≥ 11 Hours
Nominal/ Peak deviation	± 65KHz	Overall Dimensions	95 x 65 x23(mm)
Frequency Set-Up	Manual key setting or infrared transmission		
Gain Adjustment Range	4 level adjustment setting, every 3dB step		
Current Consumption	130mA		
Net Weight (without battery)	100g		

8



關注更多產品
請掃二維碼關注我們官網
More Products
Please Scan QR Code to
Follow us official website



使用微信“掃一掃”
關注我們微信公總號
Use WeChat Scan
QR Code to Follow us on WeChat

引言

Relacart CR-2 是一款性價比極高的一拖二UHF無線麥克風系統，可兼容智能手機（3.5mm接口）、數碼/單反相機、便攜式攝像機、錄音機、平板電腦等設備輔助拾取高保真音頻；此商品適合採訪、微電影錄制或商業演示等等的應用場合。主要特點是發射機和接收機均采用高亮度的OLED顯示屏顯示出相應的產品信息并且支持中英文語言選擇。紅外線自動對頻并鎖定被選擇的應用頻點。發射機支持Mic和Line接口，音量調節、RF輸出功率調節等。接收機支持耳機和輸出音量調節、自動AFS自動掃描幹淨頻點、當前應用連接掃描功能等。有效工作距離約60米。

特點

- ◆ UHF一拖二無線傳輸，提供高保真的音源；
- ◆ 廣泛兼容智能手機、數碼單反相機、便攜式攝像機、錄音機、個人電腦；
- ◆ DSP數字音頻壓擴，採用48KHz音頻採樣率，將無線傳輸系統中的噪聲降至最低，并且有效地還原被拾取的聲音；
- ◆ 輸出音量和監聽耳機音量可獨立調節；
- ◆ 多個可切換頻點或自動搜索幹淨頻點，實現無環境干擾的操作；
- ◆ 發射功率可調；
- ◆ 紅外線自動對頻并鎖定相應頻點；
- ◆ 採用OLED顯示屏顯示相應的產品信息，亮度可調節，并且支持中英文語言選擇；
- ◆ 接收機和發射機均由兩節AA電池供電；

腰包接收器

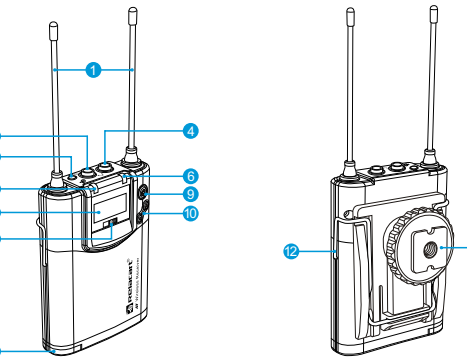

- 1 接收天線。
- 2 電源/靜音開關：長按打開或關閉電源/短按靜音。
- 3 3.5mm音頻輸出接口。
- 4 3.5mm耳機監聽接口。
- 5 藍色：RX1信號輸入指示；紅色閃爍：低電量指示。
- 6 藍色：接收器與發射器連接成功；紅色：峰值指示；紅色閃爍：音頻靜音指示。
- 7 OLED顯示屏：顯示頻率和通道，當前電池電量等信息。
- 8 紅外對頻傳輸窗口。
- 9 “⚙️”按鈕：確認更改菜單設置并輸入顯示參數。
- 10 “▲/▼”按鈕：進入菜單設置。
- 11 電池倉：使用兩節AA電池。
- 12 腰帶夾：將接收器固定在用戶腰部周圍或裝配到靴座適配器把柄凹槽內。
- 13 靴座適配器：在攝像設備上安裝和固定麥克風。

腰包發射器

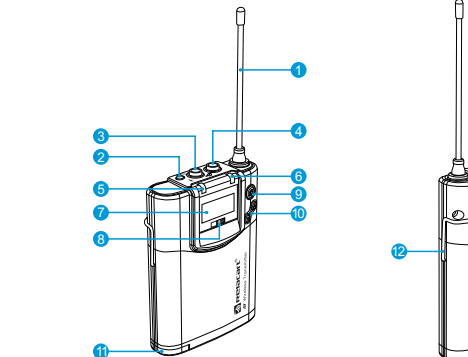

- 1 發射天線。
- 2 電源/靜音開關：長按打開或關閉電源/短按靜音。
- 3 3.5mm麥克風輸入接口。
- 4 3.5mm音頻輸入接口。
- 5 藍色：電源指示；紅色閃爍：低電量指示。
- 6 藍色：音頻電平指示；紅色：峰值指示；紅色閃爍：音頻靜音指示。
- 7 OLED顯示屏：顯示頻率和通道，當前電池電量等信息。
- 8 紅外對頻傳輸窗口。
- 9 “⚙️”按鈕：確認更改菜單設置并輸入顯示參數。
- 10 “▲/▼”按鈕：進入菜單設置。
- 11 電池倉：使用兩節AA電池。
- 12 腰帶夾：將發射器固定在用戶腰部周圍。

OLED 顯示屏操作說明

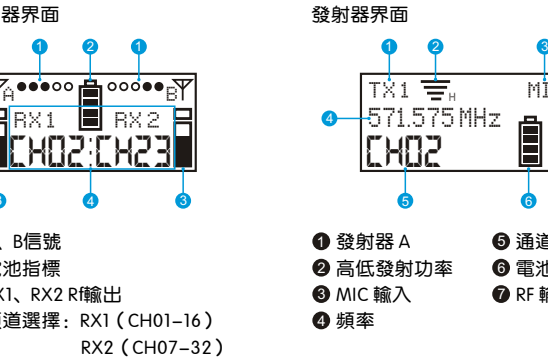

設置接收器或發射器菜單，請按照以下步驟操作：
1. 按“▲/▼”按鍵，進入菜單設置。
2. 再按“▲/▼”按鍵，滾動菜單欄。
3. 按“⚙️”按鍵，進入編輯/確認菜單設置。

如何設置“單聲道”和“立體聲”
1. 按“▲/▼”（“▲/▼”選擇）按鈕，選擇“單聲道”或“立體聲”。
2. 按“⚙️”按鍵，確認設置。

重要提示：出廠時的設置模式為“單聲道”。

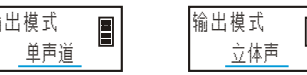

後續的設置會存儲在內存中，下次打開發射器時，會自動與上次關閉時設置的模式一致。

如何連接接收器與發射器

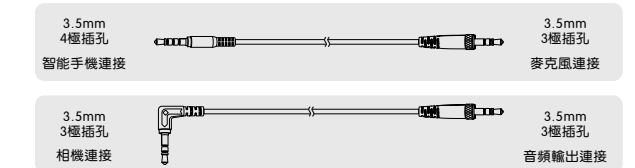
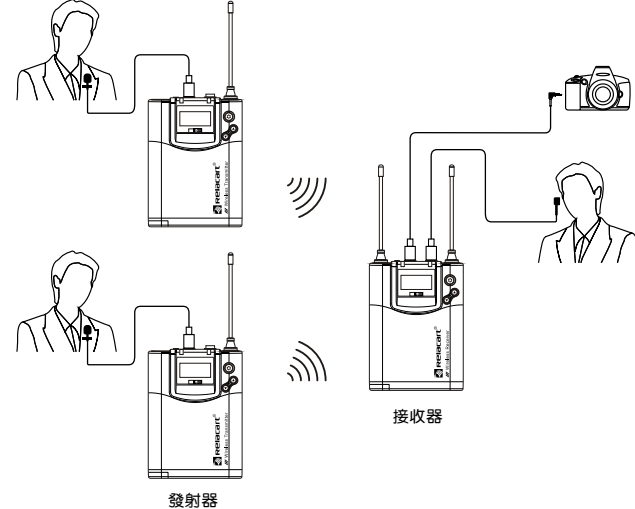

*請根據您使用的設備講電纜連接到與上圖相同的終端。

安裝或拆卸靴座適配器

安裝靴座適配器

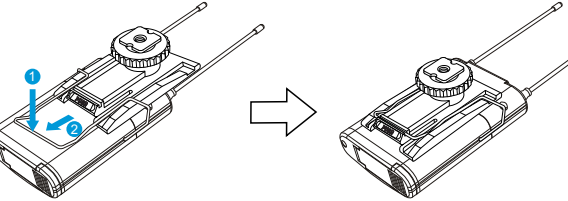

推動腰帶夾底部（1），使腰帶夾和接收器之間產生一定的空間，將腰帶夾對準靴座適配器上的兩個垂直凹槽，然後按照箭頭方向插入適配器（2），充分推入靴座適配器，直到腰帶夾裝配到適配器把柄上的水平凹槽內。

拆卸靴座適配器

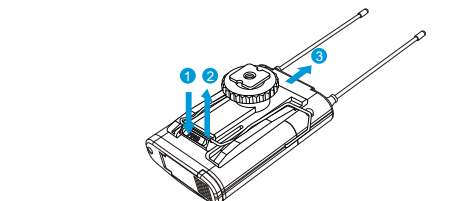

推動并握住靴座適配器上標有“PUSH”的位置（1），將腰帶夾的水平部分從靴座適配器上的水平、凹槽分離（2），然後，按箭頭方向推動靴座適配器（3）。

接收器與發射器配對

出廠前，每個產品的發射器和接收器已配對設置，開機可直接使用。

如果發射器和接收器的無線電信號已經連接正常，接收機的藍色指示燈會長亮，顯示屏的參數與發射器的一致；若是沒有連接上，接收器指示燈不亮。

注意：

接收器的通道1和通道2可以單獨調節，當使用兩個發射器時，發射器1和發射器2不需要保持相同的頻道。

祇需要將接收器的CH-A設置為與發射器CH-A相同的頻道，將接收器的CH-B設置為與發射器CH-B相同的頻道即可。

1. 如果您使用多個CR-2無線麥克風系統，請確保將每個系統設置為不同頻道，這樣可以減少互相干擾的可能性。
2. 如果發射器和接收器連接，則接收器的狀態燈保持藍色。反之，如果接收器的狀態燈熄滅，則表示發射器和接收器斷開連接。
3. 設置結果會自動保存在內存中，再次打開發射器和接收器，頻道、通道等信息會與上次設置的一致。
4. 將耳機插入接收器監聽，耳機音量較低時，可逐漸將音量調到舒適音量以監聽傳輸。
5. 確定傳輸質量良好後，安裝發射器和接收器。
6. 當您設置傳輸通道時，發射器不能用于傳輸信號。
7. 設置傳輸通道時請勿取出電池。

但是，如果所選頻道有噪聲，請執行以下步驟：

1. 按下發射器的“▲、▼”按鍵，進入菜單設置。
2. 接收器將自動與發射器連接。
3. 選擇頻道，直到您聽到清晰的聲音。

產品規格

CR-2			
RF 載波頻率範圍	470MHz~960MHz	動態範圍	85 dB
頻率穩定度	0.005%	信噪比（A計權）	80 dB
音頻頻率響應	50Hz ~ 1600Hz ±3dB	音頻採樣率	48 KHz
音頻壓擴	DSP 數字音頻壓擴		
有效工作距離（理想環境）	≥60 M		
總諧波失真	≤1%，@1KHz		
工作溫度範圍	-10℃ ~ +50℃		

CR-2R

接收帶寬	470MHz~960MHz	輸出阻抗	400 Ω
接收方式	超外差式	電池使用時間	≥7 Hours
鏡像抑制	45dBm	供電方式	AA 1.5V x 2
最大輸出電平	LINE: 0.5Vpp ; Phone: 1Vpp	正常工作電流	3V 160mA
靜噪調節	內置設定參數	外形尺寸	95 x 65 x23(mm)
射頻量敏度	輸入10dBu 時，S/N ≥45dB		
頻率同步方式	手動式按鍵設置或紅外線傳輸		
輸出電平調節範圍	9級可調，衰减式調節，每2dB步進		
淨重（不含電池）	100g		

CR-2T

載波帶寬	470MHz~960MHz	諧波輻射	-32dBm
振盪方式	PLL 頻率合成	調制方式	FSK
發射功率	13.5 dBm	最大輸入電平	250mV
載波誤差	0.005%	輸入阻抗	2.2KΩ
供電方式	AA 1.5V x2	電池使用時間	≥11 Hours
標稱/最大頻偏	±65KHz	外形尺寸	95 x 65 x23(mm)
頻率設置	手動式按鍵設置或紅外線傳輸		
輸入增益調節範圍	4級可調節設置，每3dB步進；		
正常工作電流	130mA		
淨重（不含電池）	100g		